

合計 2292m²

町民運動広場整備工事

芝生剥取り面積図

NO.	a	b	c	S	面積
1	8.810	9.862	17.064	17.8680	32.277
2	17.064	3.626	19.058	19.8740	27.211
3	19.058	4.023	21.752	22.4165	30.334
4	21.752	2.989	23.342	24.0415	28.471
5	23.342	2.795	24.617	25.3770	29.771
6	24.617	16.719	32.620	36.9780	200.887
7	16.719	2.659	14.254	16.8160	7.692
合計					356.643

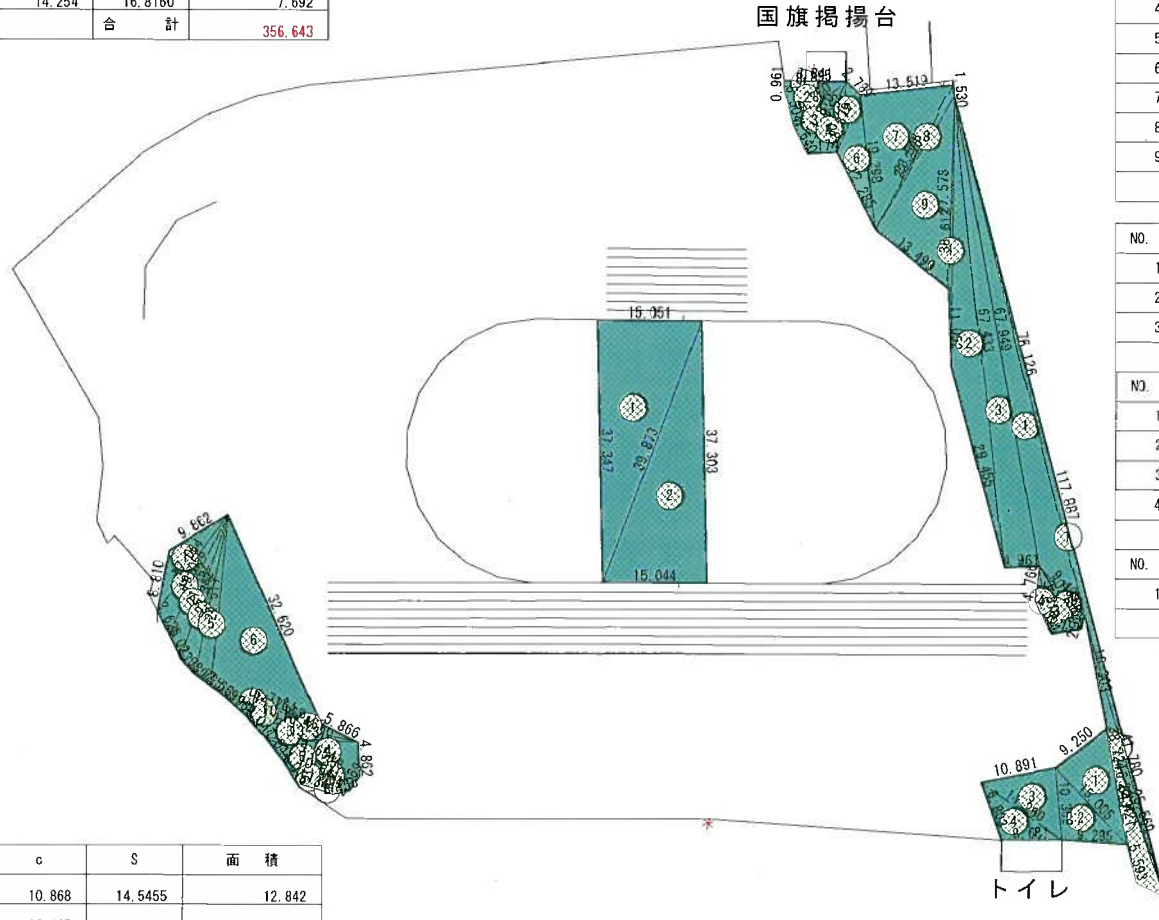

NO.	a	b	c	S	面積
1	8.841	0.961	8.895	9.3485	4.248
2	8.895	9.850	5.504	12.1245	24.282
3	9.850	11.810	4.640	13.1500	22.245
4	11.810	10.253	4.174	13.1185	20.975
5	10.253	2.789	8.879	10.9605	11.485
6	8.879	19.298	12.285	20.2310	41.263
7	19.298	13.519	23.548	28.1825	130.445
8	23.548	1.530	22.276	23.6770	9.735
9	22.276	27.578	13.499	31.6765	148.944
合計					413.622

NO.	a	b	c	S	面積
1	27.578	11.052	38.612	38.6210	10.287
2	38.612	67.433	29.455	67.7500	154.805
3	67.433	67.949	4.961	70.1715	166.885
合計					331.977

NO.	a	b	c	S	面積
1	67.949	9.499	76.126	76.7870	173.736
2	9.499	2.006	10.738	11.1215	7.942
3	10.738	4.282	9.810	12.4150	21.002
4	9.810	5.394	4.766	9.9850	6.471
合計					209.151

NO.	a	b	c	S	面積
1	76.126	41.780	117.887	117.8965	59.674
合計					59.674

NO.	a	b	c	S	面積
1	16.303	25.569	41.780	41.8260	28.255
2	16.303	38.724	22.421		辺長不正
合計					28.255

NO.	a	b	c	S	面積
1	5.593	16.843	22.421	22.4285	3.977
合計					3.977

NO.	a	b	c	S	面積
1	14.254	3.969	10.868	14.5455	12.842
2	10.868	5.866	16.467	16.6005	11.678
3	16.467	13.370	4.047	16.9420	19.253
4	13.370	4.862	14.654	16.4430	32.356
5	14.654	11.358	4.044	15.0280	15.052
6	11.358	2.569	10.641	12.2840	13.475
7	10.641	7.564	4.016	11.1105	11.456
8	7.564	2.455	5.344	7.6815	3.321
合計					119.433

NO.	a	b	c	S	面積
1	15.051	37.347	39.873	46.1355	280.945
2	39.873	37.303	15.044	46.1100	280.506
合計					561.451

NO.	a	b	c	S	面積
1	16.843	15.005	9.250	20.5490	69.068
2	15.005	10.359	9.285	17.3245	47.437
3	10.359	10.891	14.260	17.7550	56.127
4	14.260	8.803	8.681	15.8720	36.064
合計					208.696

町民運動広場整備工事

整地面積図

合計 11946m²

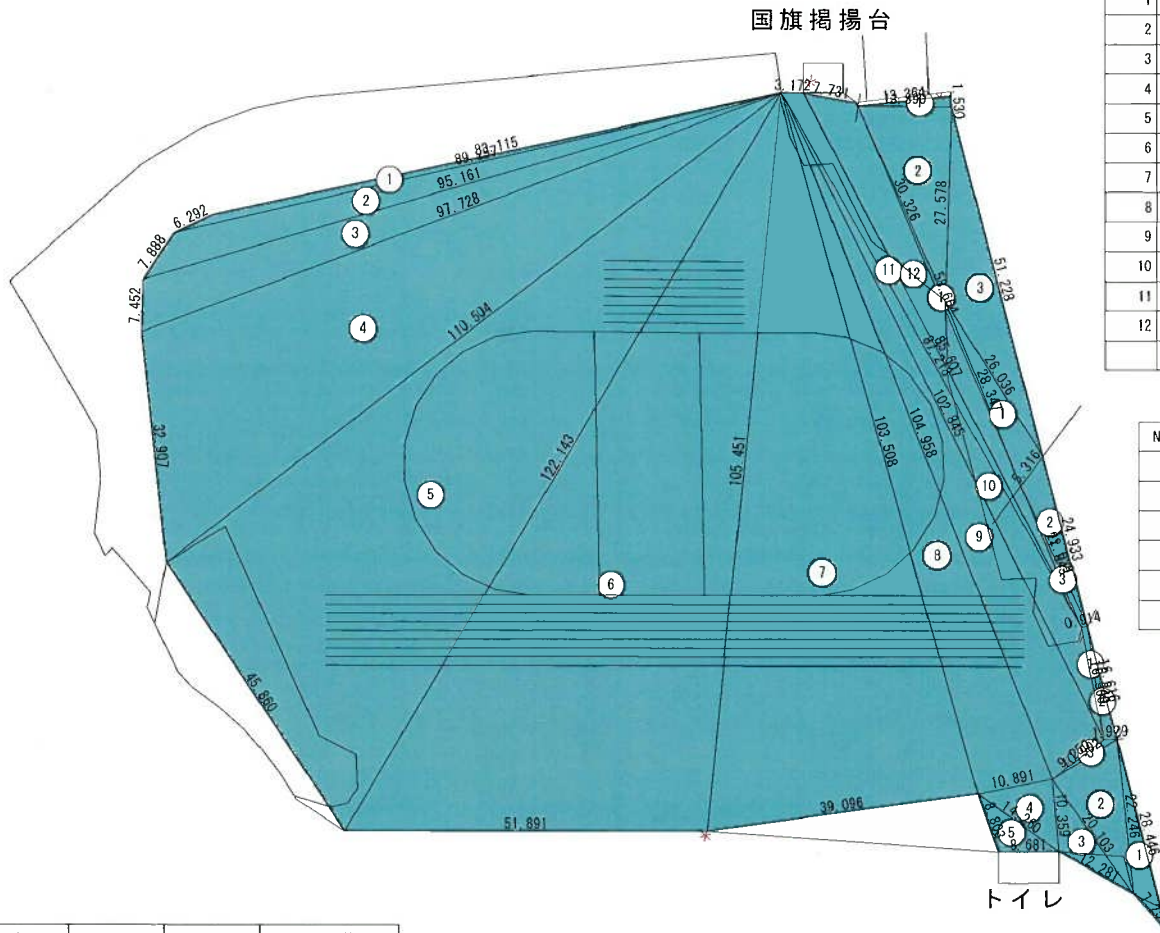

NO.	a	b	c	S	面積
1	83.115	89.257	6.292	89.3320	58.812
2	89.257	7.888	95.161	96.1530	240.952
3	95.161	7.452	97.728	100.1705	337.107
4	97.728	32.907	110.504	120.5695	1558.855
5	110.504	45.860	122.143	139.2535	2529.344
6	122.143	51.891	105.451	139.7425	2721.963
7	105.451	39.096	103.508	124.0275	2003.820
8	103.508	10.891	104.958	109.6785	561.780
9	104.958	9.250	102.845	108.5265	467.375
10	102.845	16.303	87.218	103.1830	219.941
11	87.218	85.607	3.172	87.9985	118.039
12	85.607	81.052	7.731	87.1950	259.984
				合計	11077.972

NO.	a	b	c	S	面積
1	28.446	22.246	7.259	28.9755	47.352
2	22.246	20.103	10.902	26.6255	109.356
3	20.103	12.281	10.359	21.3715	52.095
4	10.359	14.260	10.891	17.7550	56.127
5	14.260	8.681	8.803	15.8720	36.064
				合計	300.994

NO.	a	b	c	S	面積
1	30.326	28.347	58.664	58.6685	15.063
				合計	15.063

NO.	a	b	c	S	面積
1	13.364	1.530	13.390	14.1420	10.215
2	13.390	30.326	27.578	35.6470	184.566
3	27.578	26.036	51.228	52.4210	202.467
				合計	397.248

NO.	a	b	c	S	面積
1	16.303	16.340	0.914	16.7785	7.450
2	16.340	16.616	1.929	17.4425	15.703
3	1.929	10.902	9.250	11.0405	4.995
				合計	28.148

NO.	a	b	c	S	面積
1	28.347	5.316	26.036	29.8495	64.776
2	5.316	24.933	22.039	26.1440	52.028
3	22.039	0.914	21.843	22.3980	9.792
				合計	126.596